

# WATER IN THE DETAILS

Both small-scale residential fountains and a larger-scale urban project reveal that water features can be powerful without being overpowering.

BY KIM A. O'CONNELL

In his 1943 fable, *The Little Prince*, French author Antoine de Saint-Exupéry wrote famously of a "very simple" secret to the meaning of life. It is only with the heart, he wrote, "that one can see rightly; what is essential is invisible to the eye." It is a simple, even intuitive lesson, but an obviously difficult one for designers to follow. Design elements are often striking, boldly colored, or reiterated to ensure that they are seen—and seen rightly, according to their creators. Water features in the landscape are no exception. Large geometric pools with nymphs spouting curving streams of water characterize numerous gardens of prominence. An extreme example can be found at the new Bellagio Resort in Las Vegas. The extravagant hotel and casino is fronted by a large replica of Italy's Lake Como, with interconnected fountains spraying undulating waves of water in time to songs from MGM musicals. Although these ostentatious displays may please Vegas's vacationers, they are arguably feasts for the eyes more than the heart. Sometimes it is the less-showy fountain that has the power to touch one in

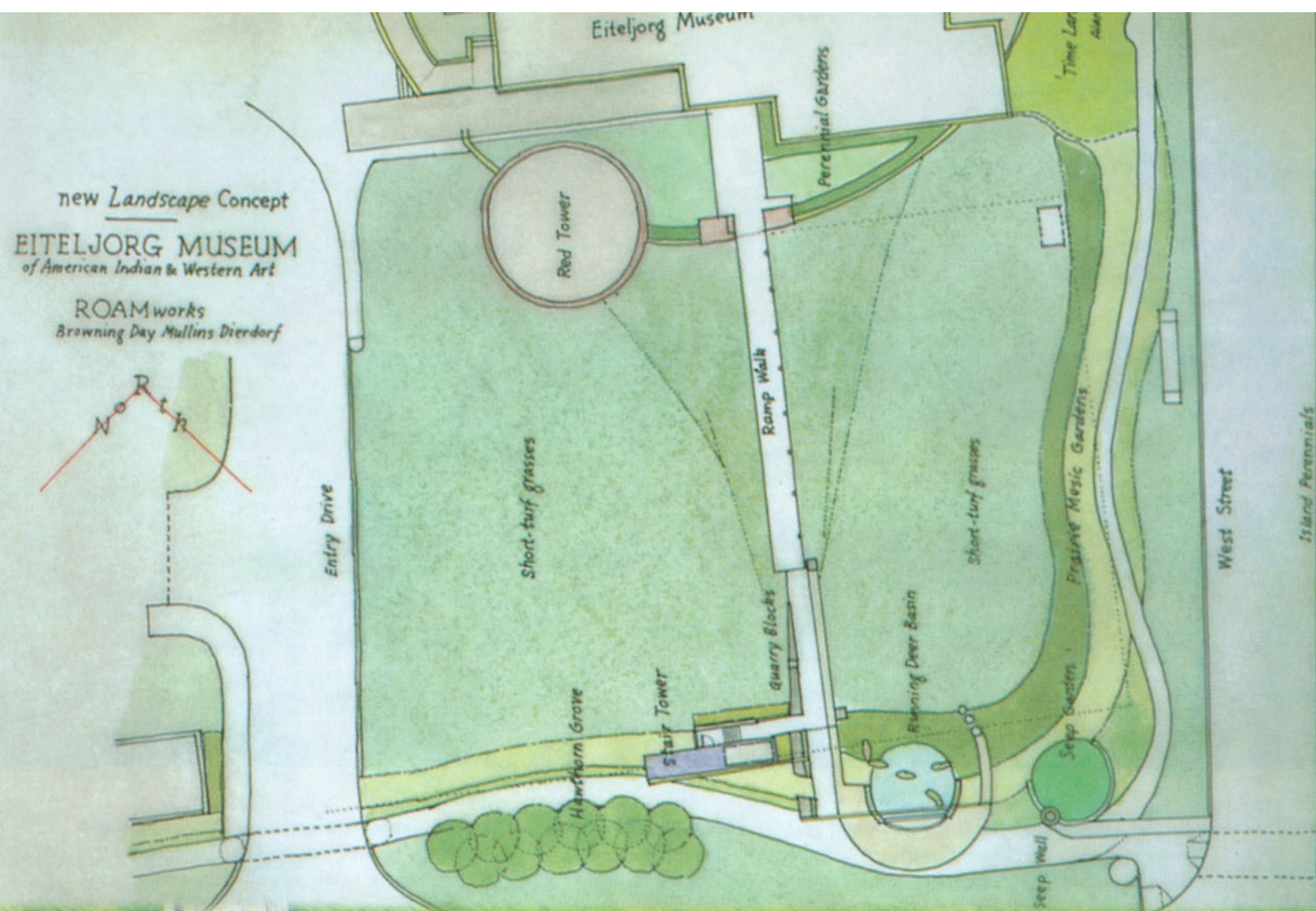

THE LIQUIDITY of the Eiteljorg Museum's native landscape is reiterated in Eric Fulford's plans for a running deer fountain and accompanying seep fountain and sedge garden, above. The striking drama of the deer fountain will be counterbalanced by the more subtle seep fountain, an understated, primitive beehive form that will ooze water into the nearby sedges, below and opposite.

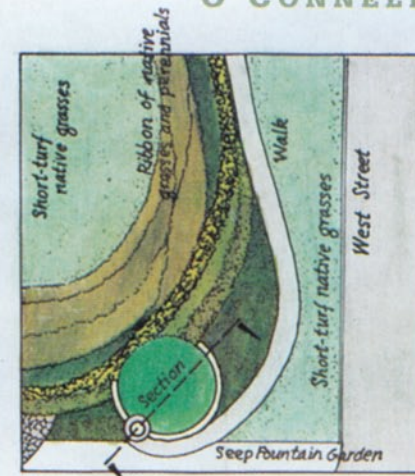
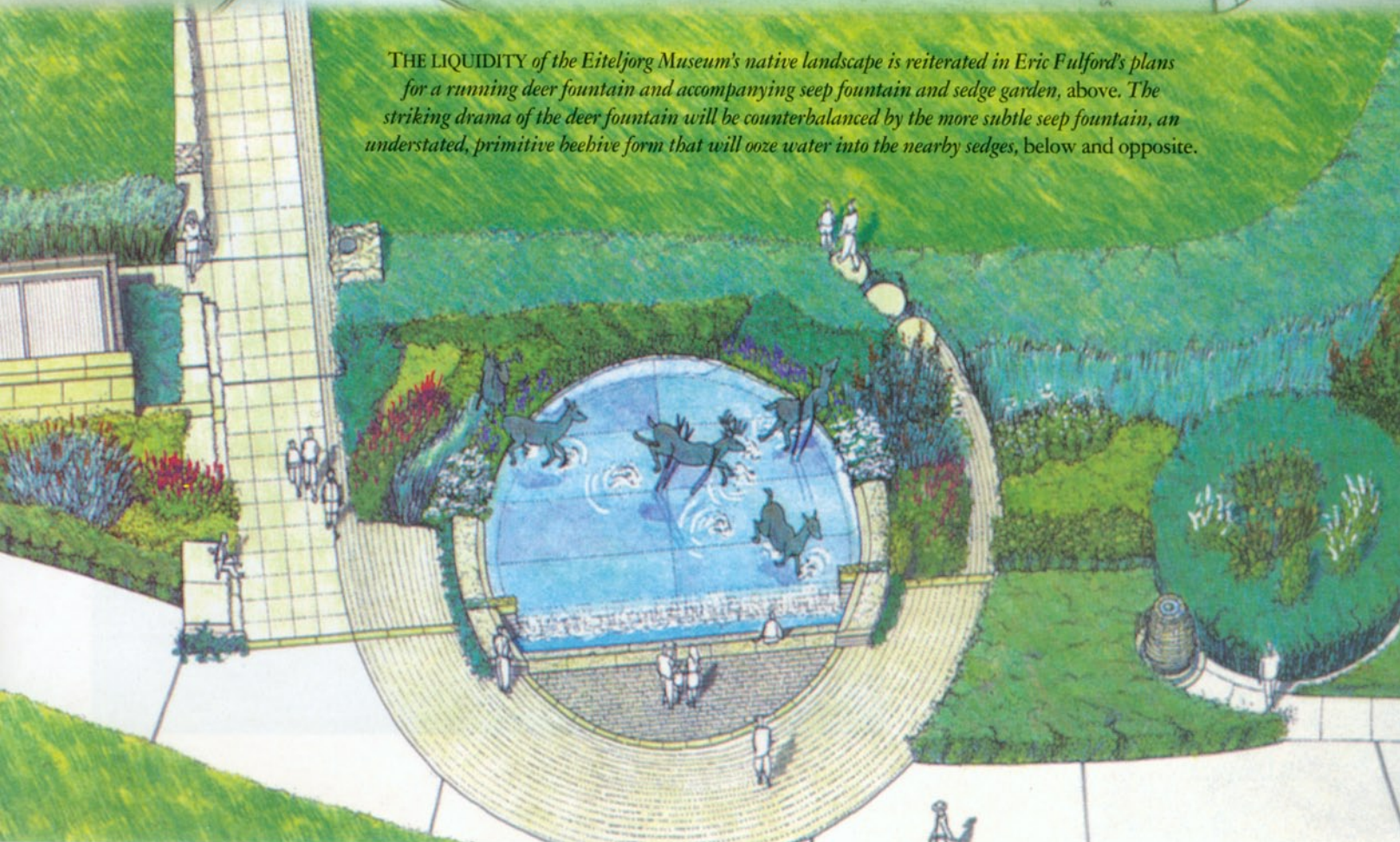

- F** 4-6 ft tall Drifts of Native Perennials that Tolerate Wet Soil
- |                        |                      |                                   |
|------------------------|----------------------|-----------------------------------|
| Asclepias incarnata    | Marsh Milkweed       | 3-4 ft, pink, July-August         |
| Aster puniceus         | Swamp Aster          | 4-6 ft, lavender, fall            |
| Eupatorium perfoliatum | Boneset              | 3-5 ft, white, August-September   |
| Filipendula rubra      | Queen of the Prairie | 4-6 ft, pink, June-July           |
| Helenium autumnale     | Autumn Sneezeweed    | 3-5 ft, yellow, September-October |

- G** 2-3 ft tall Sedges that Tolerate Wet Soil
- |                   |               |        |
|-------------------|---------------|--------|
| Carex crittella   | Crested Sedge | 2-3 ft |
| Carex stricta     | Tussock Sedge | 2-3 ft |
| Carex vulpinoidea | Fox Sedge     | 2-3 ft |

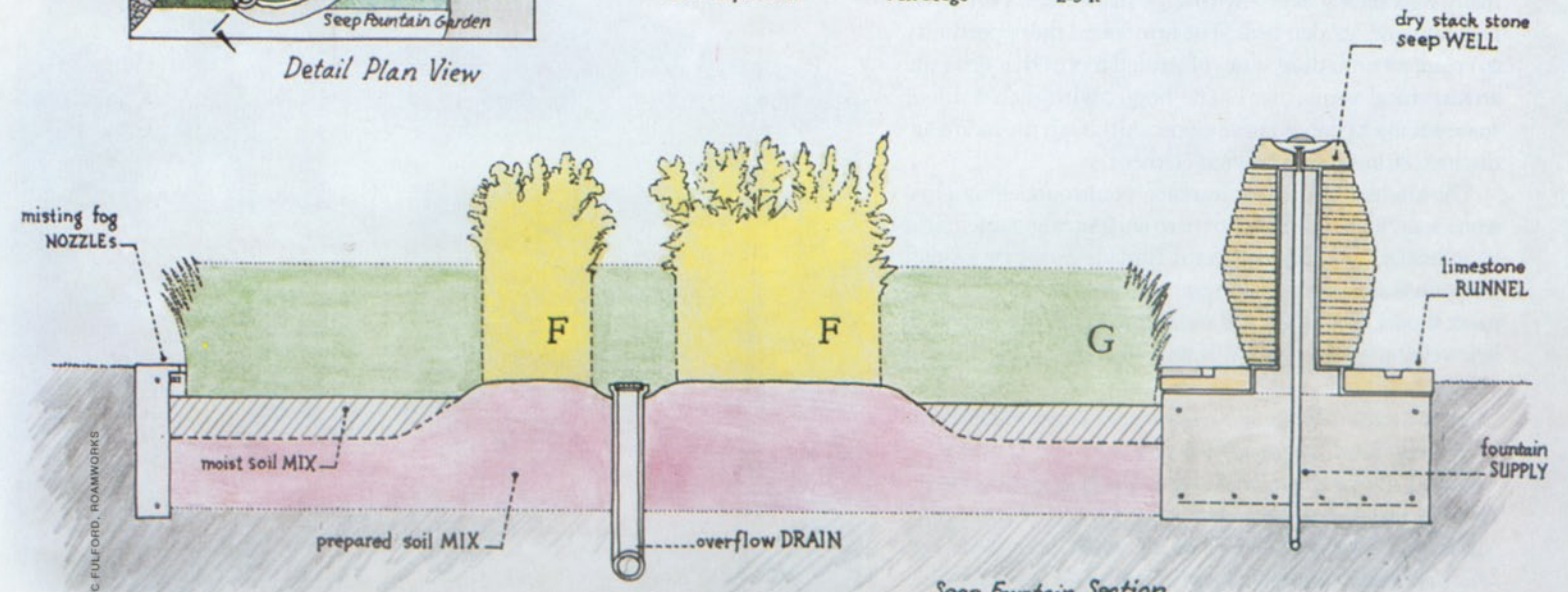

Seep Fountain Section  
EITELJORG MUSEUM  
ROAMworks